

## Motors

<b><i>Gear motors</i></b>	page 438
<b><i>Motors</i></b>	page 447
<b><i>Pump motors</i></b>	page 454
<b><i>Spindle motors</i></b>	page 459
<b><i>Timer motors</i></b>	page 460

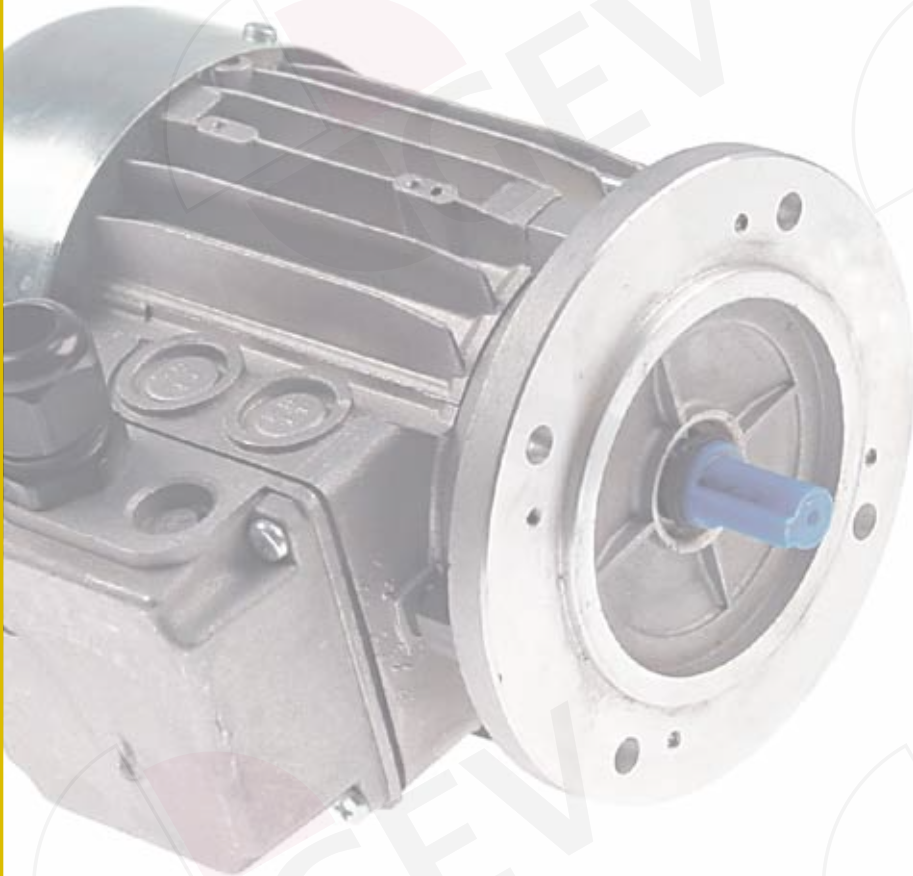

**gear motors**

for automatic coffee machines



No.	Part no.	manufacturer	type	voltage (V)	speed (rpm)	spindle ø (mm)	suitable for	equiv. no.
1	601486	-	-	230	48	15	N&W	252030
2	601488	-	-	230	70	15	N&W	251866
3	500236	CIARAMELLA	-	230	-	8	Brasilia	11735.4.00.08
4	500237	CROUZET	80881002	12	-	4	Brasilia Rossi	12220.2.00.08 3288
5	500935	CROUZET	82861080	24	-	4	Cimbali	484603000
6	500316	LIP	066C	230	12	-	Nuova Simonelli	04600001



No.	Part no.	manufacturer	type	voltage (V)	speed (rpm)	spindle ø (mm)	suitable for	equiv. no.
7	500235	LIP	51	24	9	6x8	Brasilia	10155
8	601490	LIP	111	230	8	6x8.5	N&W	98708

for bratt pans



No.	Part no.	manufacturer	type	voltage (V)	freq. (Hz)	ph.	speed (rpm)	spindle ø (mm)	suitable for	equiv. no.
1	500615	-	156B4	230/400	50/60	3	0.48/0.58	24	Ambach	5061207235
2	500349	-	MB564A	230	50	1	-	14	Modular	66401000
3	500627	CROUZET	82222006	230	50	1	-	7x8	Electrolux Zanussi	002144 002144
4	500348	ERREKA	65-T2100CF01	230	50	1	0.27	59.5	Fagor	X343000

for dishwashers



No.	Part no.	type	voltage (V)	freq. (Hz)	ph.	spindle ø (mm)	suitable for	equiv. no.
1	500194	-	230/400	50/60	3	25	ATA	9620
2	500783	71	230/400	50/60	3	-	Fagor	Z275073
3	600041	404988	24	-	-	7.5	Winterhalter	3116062
4	500930	S01-M1C6/4	230/400	50/60	3	14	Winterhalter	3116070

Motors

for dosers



No.	Part no.	manufacturer	type	voltage (V)	speed (rpm)
1	361225	CROUZET	82048054	24	65
2	361205	CROUZET	82048055	24	36

No.	Part no.	manufacturer	type	voltage (V)	speed (rpm)
3	361202	METEOR	MOD956UL/T60	230	1
4	361203	METEOR	MOD956UL/T60	230	20

for drink dispensers

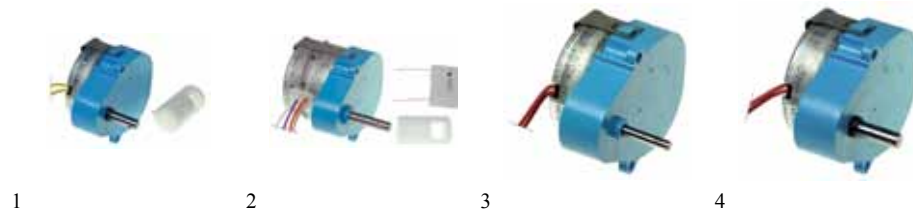

No.	Part no.	manufacturer	type	voltage (V)	freq. (Hz)	speed (rpm)	spindle ø (mm)	suitable for	equiv. no.
1	500910	FIBER	G02510BAF81	12	50/60	40	6	CAB	FB209
2	500908	FIBER	G03520AASC3	24	50	20	6	CAB	F023/3
3	500911	FIBER	G025J0BAFM	230	50/60	40	4	CAB	L8102
4	500907	FIBER	G025J0BAFHA	230	50/60	40	6	CAB	P201



No.	Part no.	manufacturer	type	voltage (V)	freq. (Hz)	speed (rpm)	spindle ø (mm)	suitable for	equiv. no.
1	500909	KENTA	CD79F	115/230	50/60	33/40	6x12	CAB	F033

for grills

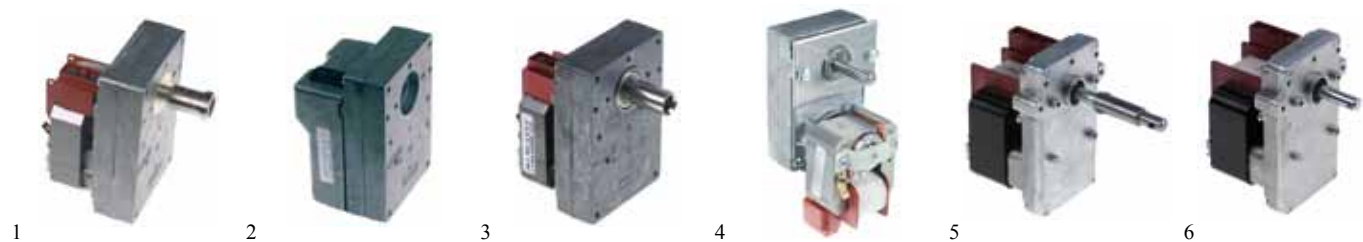

No.	Part no.	manufacturer	type	voltage (V)	freq. (Hz)	speed (rpm)	spindle ø (mm)	suitable for	equiv. no.
1	500795	BITRON	-	-	-	2	15	Chergui	03KEMO0180
2	500929	BITRON	97109	230	50	1.8	6x8	Naomi-Grills	gear motor SH.B.2G.
3	500800	BITRON	39700022	230	50	1.9	15	Chergui	03KEMP0060
4	500799	BITRON	39700023	230	50	1.9	9	Chergui	03KEMO0120
5	500977	KENTA	K9115153	230	50	5	9	North	HCR1
6	500978	KENTA	K9115153	230	50	5	9	North	HCR1_B



No.	Part no.	manufacturer	type	voltage (V)	freq. (Hz)	speed (rpm)	spindle ø (mm)	suitable for	equiv. no.
7	500499	TRIAL	MR5	230	-	-	-	Universo	GES20026
8	500495	TRIAL	R5/F004	230	50/60	-	5/8	CF RM-Gastro	63.7.0751 637075100

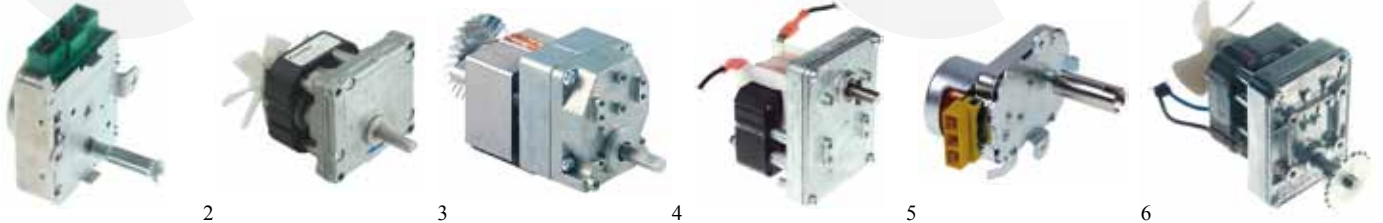

No.	Part no.	manufacturer	type	voltage (V)	freq. (Hz)	speed (rpm)	spindle ø (mm)	suitable for	equiv. no.
1	500490	-	323	230	50/60	-	9	Modular	66402600
2	500497	HEIDOLPH	607113018820	230	50	1/3	6x8	Silanos	904191
3	601126	KELVIN	K80640	230	50	4.5	9/10	Tecno MCM Tecno-MCM	020112 020112
4	500796	MERKLE-KORFF	B4415UI	230	50	4.5	8	Chergui	03KEMO0080
5	500768	METEOR	981	230	50	2	16	CB	-
6	500603	RMS	HGF06R005	230	50	-	8	Roller-Grill	A03038



No.	Part no.	manufacturer	type	voltage (V)	freq. (Hz)	speed (rpm)	spindle ø (mm)	suitable for	equiv. no.
1	500498	-	-	-	-	-	24	Star10	079501
2	500801	-	-	230	-	-	-	MKN	203039
3	500493	-	-	230	-	-	-	Suprema	Motor kpl. Mod.4/3
4	500492	-	-	230	50	-	18	Haka	9135
5	500602	CROUZET	82662563	230	50/60	4	42.5	Roller-Grill	A03007
6	500704	SPG	K225	230	50/60	2/2.5	11x12	Chergui	03KEMO0120

for gyro grills

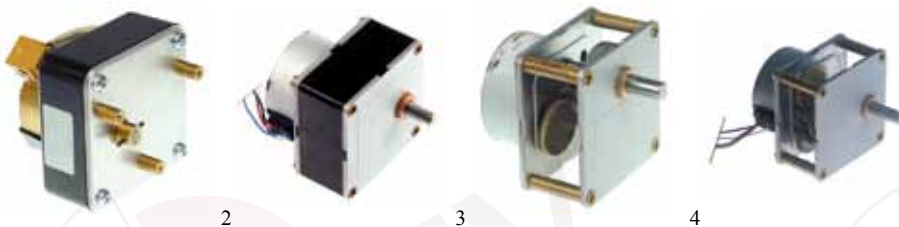

No.	Part no.	manufacturer	type	voltage (V)	freq. (Hz)	speed (rpm)	spindle ø (mm)	suitable for	equiv. no.
1	500805	AEG	M008	230	50/60	2	10	Electrolux King	01050015 01050015
2	500605	CROUZET	805274	230	50	1	7x8	Inoksan	10130100
3	500803	CROUZET	80527402	230	-	1	-	Naomi-Grills	101A
4	500969	CROUZET	80527414	230	50	1	8	CB	-



No.	Part no.	manufacturer	type	voltage (V)	freq. (Hz)	speed (rpm)	spindle ø (mm)	suitable for	equiv. no.
5	500608	CROUZET	89945210	230	50	1	8	Inoksan	10130104
6	500070	POTIS	206	230	50	1	8	Potis	PT0153
7	500502	POTIS	208	230	50	2	8	Potis	PT0156

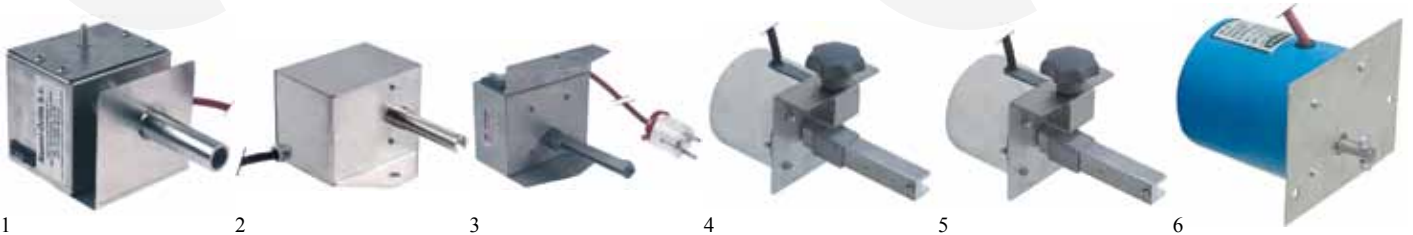

No.	Part no.	manufacturer	type	voltage (V)	freq. (Hz)	speed (rpm)	spindle ø (mm)	suitable for	equiv. no.
1	500682	-	-	230	-	1	24	Naomi-Grills	100
2	500877	-	-	230	-	1.8	18	CB	14080053
3	500606	INOKSAN	208	230	50	-	16x19	Inoksan	24011340
4	500504	POLYDOR	28/1.5	230	50	-	20	Polydor	201530
5	500509	POLYDOR	450/1.5	230	50	-	20	Polydor	201550
6	500500	POLYDOR	850/1.5	230	50	-	10	Polydor	201570



No.	Part no.	manufacturer	type	voltage (V)	freq. (Hz)	speed (rpm)	spindle ø (mm)	suitable for	equiv. no.
7	500785	POTIS	-	12	-	1	18	Potis	PT0161
8	500797	POTIS	-	230	50	1	18	Potis	PT0152
9	500879	URAL	-	230	50	1	19	Meltem	GM-02



No.	Part no.	manufacturer	type	voltage (V)	freq. (Hz)	speed (rpm)	spindle ø (mm)	suitable for	equiv. no.
1	500748	-	-	230	50	5	-	Roller-Grill	A03054
2	500868	-	323	230	50/60	-	9	Star10	079515
3	500976	BITRON	97172	230	50	1.8	8.5	North	GG1
4	500600	CROUZET	80644024	230	50/60	-	15	Roller-Grill	A03025
5	500607	CROUZET	89945210	230	50	1	12x12.5	Inoksan	24023040
6	500869	KENTA	K9113077	230	50	0.5	8.5	Star10	079513



7

No.	Part no.	manufacturer	type	voltage (V)	freq. (Hz)	speed (rpm)	spindle ø (mm)	suitable for	equiv. no.
7	500993	KENTA	K9175001	230	50	1	8	Roller-Grill	A03055

for ice-cube maker  
for paddels



1

2

3

4

5

No.	Part no.	manufacturer	type	voltage (V)	freq. (Hz)	speed (rpm)	spindle ø (mm)	suitable for	equiv. no.
1	500415	FIBER	G0251AMAKOO	12	50/60	30	12	Staff	90/82014000
2	500487	FIBER	G03550AABEA	230	50	25	4	Brema	23341
3	500991	FIBER	GE15JAMAD00	230	-	-	12	Staff	9082013500
4	500413	FIBER	M51BJ0L0001	230	50/60	25	4	Brema	23194
5	500420	FIBER	W0100ALAD00	230	50	5	12	Staff	90/82012000



1

2

3

4

No.	Part no.	manufacturer	type	voltage (V)	freq. (Hz)	speed (rpm)	spindle ø (mm)	suitable for	equiv. no.
1	500421	-	-	230	50	-	-	Eurfrigor Nuova Simonelli	RG003650 16000143
2	500424	-	-	230	50	-	6	ITV	205201
3	500407	BITRON	97101	230	50	48	4	Eurfrigor Icematic SF-Maschinen	RG000636 19440059/0 I-184
4	500422	CROUZET	SJ-1219-10	230	50	30	6	ITV	105364

for sumps



No.	Part no.	manufacturer	type	voltage (V)	freq. (Hz)	speed (rpm)	spindle ø (mm)	WL (mm)	suitable for	equiv. no.
1	500411	BITRON	97103	230	50	0.7	7	30	Icematic Scotsman SF-Maschinen Simag	19440057/0 CM19440057 I-305 CM19440057
2	500410	ELETTROVAGO	330N	230	50	0.7	7	23	Icematic Scotsman SF-Maschinen Simag	19440065/0 CM19440065 I-309 CM19440065
3	500409	LIP	001	230	50	0.7	7	20	Icematic Scotsman SF-Maschinen Simag	19440063/0 CM19440063 I-303 CM19440063
4	500412	LIP	021B	230	50	1	7	20	Icematic Scotsman SF-Maschinen Simag	19440073/0 CM19440073 I-307 CM19440073
5	500688	LIP	068	230	50	1	7	20	Eurfrigor Scotsman Simag	RG000640 CM19440073 CM19440073

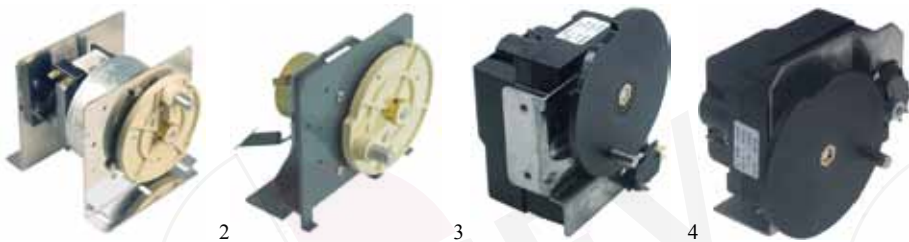

No.	Part no.	manufacturer	type	voltage (V)	freq. (Hz)	spindle ø (mm)	suitable for	equiv. no.
1	500425	-	-	230	50	10	ITV	105200
2	500423	CROUZET	80336505	230	50	10	ITV	105363
3	500786	LIP	-	230	50	8	Icematic SF-Maschinen	81404024/0 I-308
4	500756	LIP	10	230	50	8	Icematic SF-Maschinen	81442072/0 I-306



No.	Part no.	manufacturer	type	voltage (V)	freq. (Hz)	spindle ø (mm)	suitable for	equiv. no.
1	500414	-	-	230	50	8	Brema Zanussi	23195 085299
2	500402	KENTA	IC9113065	230	50	14	Staff	90/82020000

other

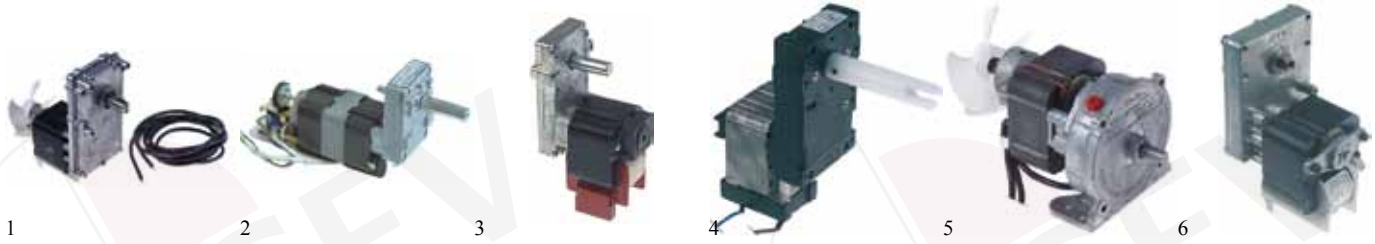

No.	Part no.	manufacturer	type	voltage (V)	freq. (Hz)	spindle ø (mm)	suitable for	equiv. no.
1	500773	-	S5814A	230	-	5	Scotsman	1200240726
2	500403	AUTOM	-	230	50	8	Staff	90/82016000
3	500914	KENTA	K9117403	230	-	12	Brema	23310
4	601539	LIP	049D	230	50	18	Icematic Scotsman	81401520/0 81401520
5	500739	MERKLE-KORFF	-	115	50	8	Scotsman	02474305
6	601518	MERKLE-KORFF	3724UP-350	230	50/60	9	Scotsman	1200161006



No.	Part no.	manufacturer	type	voltage (V)	freq. (Hz)	spindle ø (mm)	suitable for	equiv. no.
1	500675						Brema	23532
2	601445						Wessamat	32301
3	500401	-	794225	230	50/60	16x22	Giga Scotsman	179244509 79422509R
4	500792	KELVIN	-	230	50	6	ITV	105291
5	500775	MK	-	230	50	9.1	Scotsman	02465606

for microwaves



No.	Part no.	voltage (V)	freq. (Hz)	speed (rpm)	spindle ø (mm)	type	manufacturer	suitable for	equiv. no.
1	601658	230	50/60	3	5x7	-	-	-	-
2	601168	230	50/60	12	6.5x4.5	RMOTDA234WRE0	Higashifuji	Sharp	RMOTDA234WRE0
3	601169	230	50/60	12	6.5x4.5	RMOTDA238WRZZ	Higashifuji	Sharp	RMOTDA238WRZZ



for ovens  
for flues

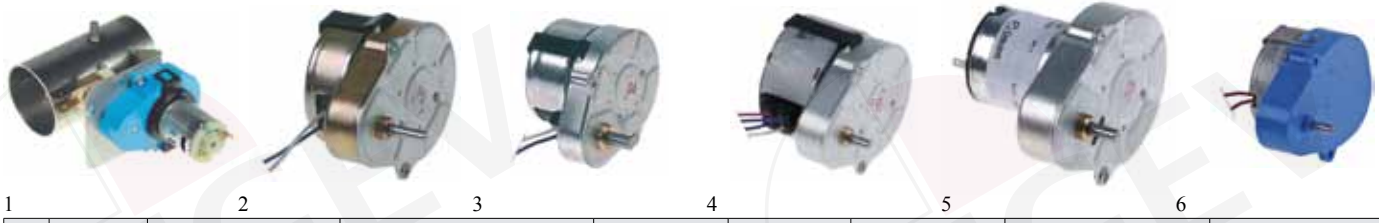

No.	Part no.	manufacturer	type	voltage (V)	speed (rpm)	spindle ø (mm)	suitable for	equiv. no.
1	500873	-	G70C10AFTEG	12	-	6	Rational	22.00.318
2	601467	CROUZET	823440	230	6	4	TurboChef	100891
3	530008	CROUZET	82334009	230	10	6x5	Fagor	T323010
4	361651	CROUZET	82524421	230	1	4	MBM Italy	RTFOC00197
5	361565	CROUZET	82841056	24	4.2	4	Rational	3101.1007
6	500670	FIBER	G025JABDAAD	230	2	4	Electrolux Juno	002696 002696

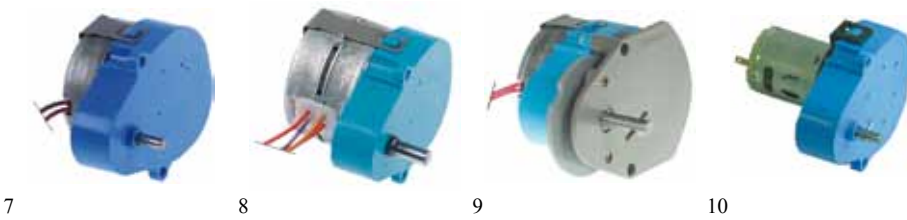

No.	Part no.	manufacturer	type	voltage (V)	speed (rpm)	spindle ø (mm)	suitable for	equiv. no.
7	500880	FIBER	G026HABDGAD	230	2	4	Electrolux Juno	004011 004011
8	601247	FIBER	G0655CABN00	230	7.5	6	Cuppone	91310530+91310540
9	360342	FIBER	P245J01C620	230	2	6	Electrolux Zanussi	0C0883 0C0883
10	601138	KROSS	G70C10AFTEG	12	-	4	Rational	3101.1010

for conveyor belt



No.	Part no.	manufacturer	type	voltage (V)	spindle ø (mm)	suitable for	equiv. no.
1	500819					Moretti	74015580
2	500820	TRANSTECNO	WM26/P522CD	24	12	Moretti	74015590
3	500809	TRANSTECNO	WM26/P522CS	48	12	Zanolli	MOTO0052



No.	Part no.	manufacturer	type	voltage (V)	freq. (Hz)	spindle ø (mm)	suitable for	equiv. no.
1	500811	AUTOM	ASR/30/FR	230	50	8	Bourgeois	MOT018
2	601470	CROUZET	80533004	230	60	8	TurboChef	HHB-3200
3	361564	ESCAP	22N28210E	24	-	5	Rational	3101.1001

for softeners



No.	Part no.	type	voltage (V)	freq. (Hz)	pinion ø (mm)	suitable for	equiv. no.
1	530330	41870120	12	50	8	Bores s.r.l.	MOTA12
2	530268	50SM13-4B	230	50	11	Bores s.r.l.	MOTF56
3	530305	G0152ACLLFL	24	50/60	28	Bores s.r.l.	MOTB3H24CI
4	530301	G0252AEEBFL	24	50	15	Bores s.r.l.	MOTM1M24CI
5	530264	M004	24	50	11	Bores s.r.l.	MOTF65

for timers



No.	Part no.	manufacturer	type	voltage (V)	freq. (Hz)	operation time (s)	speed (rpm)	spindle ø (mm)
1	360106	FIBER	G025JBJEU00	230	50	90	2/3	4
2	360107	FIBER	G025JBJFE00	230	50/60	120	0.5	4.5
3	360109	FIBER	G025JBJFT00	230	50/60	180	1/3	4.4
4	360105	FIBER	M51BJ0R0000	230	50/60	60	1	4

other



No.	Part no.	type	voltage (V)	application	suitable for	equiv. no.
1	500920	-	-	for chocolatiere	VEMA	XRCI20
2	500921	-	-	for chocolatiere	VEMA	XRCI21
3	500344	-	230	for chocolatiere	-	-
4	500730	-	230	for citrus-fruit squeezer	Sirman	IB9865132
5	500932	-	230	for pizza display	Sirman	IB5036000
6	601483	4515UI-063	230	for toaster	Hatco	02.12.079.00



No.	Part no.	type	voltage (V)	ph.	application	suitable for	equiv. no.
7	500489	80804011	24		for toaster	Fimar Sirman	CO1680 IB5036810
8	500488	60711302410	230	1	for toaster	CB Sirman	07012401 IB5036800



No.	Part no.	type	voltage (V)	ph.	application	suitable for	equiv. no.
9	500913	B4509UI-025	230	1	refrigerated displays	Tecfrigo	00807/1
10	500632	MS56A/4	230/400	3	for boiling kettles	Küppersbusch	115975
11	500496	R5/G4.5	24		for toasters	CF	63.7.0752
12	601484	S4355L	230	1	for hot displays	Hatco	02.12.026.00

**motors**

for automatic coffee machines



No.	Part no.	voltage (V)	power (W)	spindle ø (mm)	WL (mm)	suitable for	equiv. no.
1	601495	230	-	4	27	N&W	098808

No.	Part no.	voltage (V)	power (W)	spindle ø (mm)	WL (mm)	suitable for	equiv. no.
2	601494	230	48	7.5	24	N&W	251777

for bar blenders



No.	Part no.	voltage (V)	power (W)	speed (rpm)	TS	BA (mm)	suitable for	equiv. no.
1	500791	230	200	-	-	-	VEMA	XRFR49
2	500728	230	450	18000	M6L	36	Sirman	IB5000800
3	500729	230	750	14000/24000	M8L	90	Sirman	IB5000900



No.	Part no.	voltage (V)	power (W)	speed (rpm)	spindle ø (mm)	WL (mm)	suitable for	equiv. no.
1	500731	230	100	14000	10	143	Sirman	IB9865200
2	500732	230	100	14000	18	143	Sirman	IB9865201

## for bratt pans



No.	Part no.	P (kW)	voltage (V)	freq. (Hz)	ph.	spindle ø (mm)	WL (mm)	speed (rpm)	type	suitable for	equiv. no.
1	500813	0.12	230	50	1	9	20	2750	M TUBO 56	MBM Italien	RTBF900122
2	500626	0.17	230	50	1	17	60	320/2800	20571.210	Electrolux Zanussi	056980 056980
3	500823	0.17	230	50	1	17	60	320/2800	20571252	Electrolux Zanussi	052802 052802

for coffee grinders  
complete

No.	Part no.	P (kW)	voltage (V)	freq. (Hz)	ph.	spindle ø (mm)	WL (mm)	type	suitable for	equiv. no.
1	500243	-	230	50	1	17	45	MD.80/MC4	Rancilio	34014002
2	500241	0.09	230	50	1	10	38	C002801	Bezzera Obel	OBDF15 DF15
4	500242	0.2	230	50/60	1	14	35	MC125/55	Rancilio	14000022
5	500315	0.25	230	50	1	12	36	D001302	Nuova Simonelli	04500031
6	500949	0.25	230	50	1	15	54	11004007	Wega	WY28247001



No.	Part no.	P (kW)	voltage (V)	freq. (Hz)	ph.	spindle ø (mm)	WL (mm)	type	suitable for	equiv. no.
7	500240	0.3	230	50/60	1	-	47	102.000C	Obel	DF15

## component parts



No.	Part no.	voltage (V)	freq. (Hz)	ph.	ø (mm)	int. ø (mm)	H (mm)	spindle ø (mm)	suitable for	equiv. no.
1	500239	230	50	1	100	65	195	16	Fiorenzato Obel	190067 EB73
2	500238	230	50	1	110	65	160	14	Fiorenzato	190050

for cream whipping machines



1

No.	Part no.	P (kW)	voltage (V)	freq. (Hz)	ph.	spindle ø (mm)	Fø (mm)	speed (rpm)	type	suitable for	equiv. no.
1	500701	0.41	230	50	1	15	79	1400	RM80B4	Telme	M01.042.R

for cutter



No.	Part no.	voltage (V)	spindle ø (mm)	WL (mm)	ø (mm)	H (mm)	BA (mm)	suitable for	equiv. no.
1	500897	230	20	25	100	140	64	Sirman	MSC04N136

for ice-cube maker complete



1

2

3

4

5

No.	Part no.	P (kW)	voltage (V)	freq. (Hz)	ph.	spindle ø (mm)	speed (rpm)	type	suitable for	equiv. no.
1	500872	0.09	230	50/60	1	10	1400/1600	MPMF/60-4P	Linea Blanca	A039202
2	500793	0.12	230	50/60	1	10	1390/1600	RM63/50	ITV	105261
3	500871	0.12	230	50/60	1	10	1390/1600	RM63/50	Linea Blanca	A039201
4	500787	0.18	230	50/60Hz	1	12.8	1300	-	Eurfrigor	RG000647
5	500745	0.2	230	50/60	1	16	-	7942150305	Scotsman	06027303



7

No.	Part no.	P (kW)	voltage (V)	freq. (Hz)	ph.	spindle ø (mm)	speed (rpm)	type	suitable for	equiv. no.
7	500727	0.35	230	50	1	-	12000	-	Sirman	IB5000801

## rotors



No.	Part no.	ø (mm)	spindle ø (mm)	WL (mm)	suitable for	equiv. no.
1	500751	65	13	180	Scotsman	79412303R

No.	Part no.	ø (mm)	spindle ø (mm)	WL (mm)	suitable for	equiv. no.
2	500774	79	16	52	Scotsman	79421600R

## stators



No.	Part no.	voltage (V)	freq. (Hz)	ph.	ø (mm)	int. ø (mm)	H (mm)	suitable for	equiv. no.
1	500747	230	50	1	101	59	51	Scotsman	00140026
2	695826	230	50/60	1	135	80	45	Icematic Scotsman	29000010/0 62029500

## for gyro slicers



No.	Part no.	spindle ø (mm)	Fø (mm)	type	L (mm)	suitable for	equiv. no.
1	401567					Gastro Technik Lahr	Elektromotor für Dön
2	401864	20	50	314101	103	Star10	079523

for meat mincer  
complete

No.	Part no.	P (kW)	voltage (V)	freq. (Hz)	ph.	spindle ø (mm)	speed (rpm)	type	suitable for	equiv. no.
1	500866	3	230/400	50	3	19	1390	M112	Sirman	LF1839701

rotors



No.	Part no.	ø (mm)	spindle ø (mm)	WL (mm)	suitable for	equiv. no.
1	697311	89.2	25	220	Fimar	SA6800
2	500725	89.2	25	357	Fama Sirman	F2202 MF2202

No.	Part no.	ø (mm)	spindle ø (mm)	WL (mm)	suitable for	equiv. no.
3	500726	89.2	25	357	Fama Sirman	F2095 MF2095A

stators



No.	Part no.	voltage (V)	freq. (Hz)	ph.	number of poles (-poles)	ø (mm)	int. ø (mm)	H (mm)	suitable for	equiv. no.
1	500827	230	50	1	4	110	62	75	Fama	F2009
2	500825	230	50	1	4	110	66	60	Fama Sirman	F2077 MF0004
3	500828	230	50	1	4	150	90	70	Fama Sirman	F2096 MF0102
4	500830	230	50	1	6	150	103	90	Fama Sirman	F2203 MF0170
5	500829	400	50	3	4	150	83.6	50	Fama Sirman	F2097 MF0103
6	500831	400	50	3	6	150	90	70	Fama Sirman	F2204 MF0171

for microwaves



No.	Part no.	P (kW)	voltage (V)	freq. (Hz)	ph.	spindle ø (mm)	WL (mm)	Fø (mm)	speed (rpm)	type	suitable for	equiv. no.
1	500628	0.02	230	50	1	9	12	73	1400	M81A25G4GE	Electrolux Zanussi	002794 002794

for mozzarella cutter

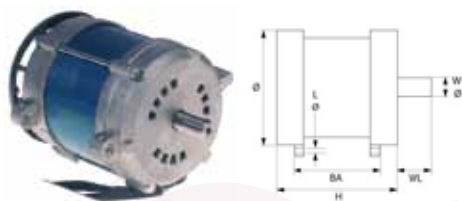

No.	Part no.	voltage (V)	speed (rpm)	ph.	spindle ø (mm)	WL (mm)	ø (mm)	H (mm)	BA (mm)	Lø (mm)	suitable for	equiv. no.
1	500722	230	1400	1	15	31	115	155	110	10	Sirman	IB5053002
2	500723	230/400	1400	3	15	31	115	155	110	10	Sirman	IB5053003
3	500716	240	1400	1	15	31	115	155	110	10	Sirman	IB5053004
4	500867	400	-	3	19	30	115	155	110	10	Sirman	IB5053403

## for potato peelers



No.	Part no.	voltage (V)	freq. (Hz)	ph.	spindle $\phi$ (mm)	WL (mm)	speed (rpm)	suitable for	equiv. no.
1	500711	230	50	1	10	21	1400	Sirman	RG04260A
2	500713	230	50	1	12	23	1400	Sirman	RG08260A
3	500712	400	50	3	10	21	1400	Sirman	RG04260B
4	500714	400	50	3	12	23	1400	Sirman	RG08260B

## for slicers

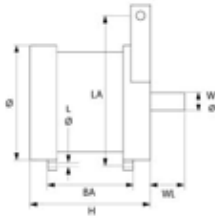

No.	Part no.	voltage (V)	ph.	speed (rpm)	spindle $\phi$ (mm)	WL (mm)	$\phi$ (mm)	H (mm)	BA (mm)	LA (mm)	L $\phi$ (mm)	type	suitable for	equiv. no.
1	500923	230	1	1380	15	28	115	87	49	145	6	H35-508	RGV	0000000508
2	500912	230	1	1380	15	28	115	92	49	145	6	H40-510	RGV	0000000510
3	500973	230	1	1380	15	28	115	112	75	145	6	H60-425	RGV	0000000425
4	500954	230	1	1380	15	28	115	112	75	145	8	H60-1150	RGV	0000001150
5	500956	230	1	1380	17	27	154	130	98	170	10	125-40/577	RGV	0000000577
6	500898	230	1	1400	15	20	125	100	71	155	6	C71/40	Sirman	19400101
7	500717	230	1	1400	15	21	135	120	63	155	8	C71/40	Sirman	SM400108
8	500718	400	3	1400	15	22	135	120	63	155	8	-	Sirman	SM402215

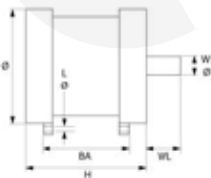

No.	Part no.	voltage (V)	ph.	speed (rpm)	spindle $\phi$ (mm)	WL (mm)	$\phi$ (mm)	H (mm)	BA (mm)	L $\phi$ (mm)	suitable for	equiv. no.
1	500992	230	1	1400	15	22	93	103	65	6	-	-
2	500721	230	1	890	16.5	32	130	140	108	8	Sirman	19400108
3	500715	230	1	1400	15	23	110	98	69	6	Sirman	AMC648
4	500901	230	1	1400	16.5	32	130	140	108	8	Sirman	19400107
5	500720	230/400	3	890	16.5	32	130	120	87	8	Sirman	19400408



for vegetable cutters



No.	Part no.	voltage (V)	power (W)	freq. (Hz)	ph.	spindle ø (mm)	WL (mm)	ø (mm)	H (mm)	BA (mm)	Lø (mm)	suitable for	equiv. no.
1	500719	230	515	50	1	14	37			154		Sirman	IV5050002

universal



No.	Part no.	P (kW)	voltage (V)	freq. (Hz)	ph.	spindle ø (mm)	Fø (mm)	speed (rpm)	type	suitable for	equiv. no.
1	500625	0.06	230	50	1	9	80	820	156C6	Tecno MCM Tecno-MCM	140020 140020
2	601463	0.09	230	50	1	9	80	1300	AMM56ZAA4	Olis	2510631
3	500876	0.09	230	50	1	9	80	1400	MM56B4	CB	07010051
4	500633	0.37	230	50	1	14	105	1400	LME71L4R3	Cuppone	91411040
5	601179	0.55	230/400	50	3	14	105	1400	T71BX4	Pizza-Group	5420800
6	500634	0.55	230/400	50	3	14	105	1400	T71C4	Cuppone	91411050
7	601180	0.55	230/400	50	3	19	120	1400	AI80A4	Pizza-Group	5420900
8	500744	0.55	230/400	50	3	19	120	1400	BN80A4	Scotsman	62048001
9	500473	0.75	230/400	50	3	19	120	1400	FS80B4	Pizza-Group	PF08300
10	500471	1.1	400	50	3	19	120	1400	YS8034	Pizza-Group	8300530
11	500472	2	400	50	3	24	140	1400	YS9034	Pizza-Group	8300540



No.	Part no.	P (kW)	voltage (V)	freq. (Hz)	ph.	spindle ø (mm)	Fø (mm)	speed (rpm)	type	suitable for	equiv. no.
1	500874	0.09	230	50	1	9	120	1400	MM56B4	CB	07010635
2	500875	0.09	230/400	50	3	9	120	1400	M56B4	CB	07011238
3	500903	0.25	230	50	1	14	160	1400	M71B4	Pizza-Group	5420200
4	500883	0.37	230	50	1	11	140	1400	M71BL4	Fimar	SL1112
5	500821	0.37	230	50	1	14	160	1400	M71BL4	Moretti Pizza-Group	74015340 5420300
6	500904	0.55	230	50	1	14	160	1400	M80B4	Pizza-Group	5420310
7	500887	0.6/0.8	400	50	3	14	160	1400/2800	DN80B2/4	Fimar	SL0939
8	500885	0.75	230	50	1	14	160	1400	M80BL4	Fimar	SL0041
9	500839	0.75	230	50	1	19	160	1400	80/4	Alimacchine	25NT20 230V
10	500840	0.75	230/400	50	3	19	160	1400	80/4	Alimacchine	25NT20 400V
11	500888	1.1	230	50	1	19	160	1400	M905B	Fimar	SL0090
12	500891	1.5	230	50	1	19	160	1400	M90L4	Fimar	SL0092
13	500890	1/1.4	400	50	3	19	160	1400/2800	DN90S2/4	Fimar	SL0940



No.	Part no.	P (kW)	voltage (V)	freq. (Hz)	ph.	spindle ø (mm)	speed (rpm)	type	BM (mm)	suitable for	equiv. no.
1	601140	0.18	230	50	1	11	1400	MDE63C4	80x100	Intimpex	6028
2	500766	0.25	220	50	1	14	1400	71	90x112	Scotsman	62031600
3	500724	0.25	230	50	1	11	2800	MY632-2	80x100	Sirman	29401502
4	500870	0.37	230	50	1	14	1400	M71BL4T	90x112	IGF	2300/B30Z15
5	500767	0.55	230/400	60	3	19	900	H80B6	100x125	Scotsman	62038302

**pump motors**

for booster pumps  
clip connection

10

Motors



No.	Part no.	type	power (W)	voltage (V)	freq. (Hz)	suitable for	equiv. no.
1	500442	11002708	165	230	50/60	-	-
2	500061	11002755	165	230	50	Astoria CMA	18300 18300
3	500458	11002778	165	230	50	Vibiemme	ELETMOT22V
4	500080	128P	180	230	50	-	-
5	500073	128PA	180	110	60	-	-
6	500233	90P	120	230	50	-	-



No.	Part no.	type	power (W)	voltage (V)	freq. (Hz)	suitable for	equiv. no.
7	500452	C004311	100	230	50/60	Vibiemme	ELETMOTRPM304
8	500317	C004320	120	230	50/60	Nuova Simonelli	04500033
9	500072	C013726	120	230	50/60	Astoria CMA	18304 18304
10	500950	C013728	120	230	50	Wega	WY18303

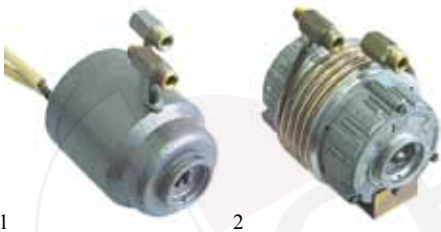

No.	Part no.	type	power (W)	voltage (V)	freq. (Hz)	suitable for	equiv. no.
1	500226	-	-	230	50/60	Astoria CMA	56402 56402
2	500225	C042200	330	230	50/60	Astoria CMA	56406 56406

flange connection



No.	Part no.	type	power (W)	voltage (V)	freq. (Hz)	suitable for	equiv. no.
1	500081	11039007	150	230	50	-	-
2	500062	11039007	150	230	50	-	-
3	500689	C021002	60	230	50/60	Thermoplan	91.39.10
4	500076	SEC10256/A	170	230	50/60	Faema	2441-116600
5	500077	SEC10256/B	170	230	50/60	Faema	2441-133416

accessories

pump heads

FLUID-O-TECH



No.	Part no.	type	L (mm)	flow rate (L/h)	connection	material	fixing	suitable for	equiv. no.
1	500918	CA104	60	100	3/8" GAS	brass	clip connection	-	-



No.	Part no.	type	L (mm)	flow rate (L/h)	connection	material	fixing	suitable for	equiv. no.
1	500078	FA204	75	250	3/8" GAS	brass	flange with 2 holes	Faema	-
2	500065	PA204F	82	200	3/8" NPT	brass	flange with 3 holes	Faema	-



No.	Part no.	type	L (mm)	flow rate (L/h)	connection	material	fixing	suitable for	equiv. no.
1	500765	MA104	75	100	3/8" GAS	brass	clip connection	-	-
2	500174	PA104	82	100	3/8" GAS	brass	clip connection	Nuova Simonelli Wega	01300004 WY26303001
3	500211	PO054	82	50	3/8" GAS	brass	clip connection	-	-
4	500074	PO104	82	100	3/8" GAS	brass	clip connection	-	-
5	500064	PO204	82	200	3/8" GAS	brass	clip connection	Astoria Brasilia Cimbali CMA Futurmat Gaggia Italcrem la SCALA S.r.l. Mairali ...	26303 04321.4.00.08 533-197-300 26303 07822109 - 07822109 C-0521 07822109 ...



1

No.	Part no.	type	L (mm)	flow rate (L/h)	connection	material	fixing	suitable for	equiv. no.
1	500068	PA311	82	300	3/8" GAS	stainless steel	clip connection	-	-



No.	Part no.	type	L (mm)	flow rate (L/h)	connection	material	fixing	suitable for	equiv. no.
1	500177	PA204X	82	200	3/8" GAS	brass	clip connection	-	-
2	500176	PO104X	82	100	3/8" GAS	brass	clip connection	Bezzera	7730506

## PROCON



1

No.	Part no.	type	L (mm)	flow rate (L/h)	connection	material	fixing	suitable for	equiv. no.
1	500293	T1039	82	180	3/8" NPT	brass	flange with 3 holes	-	-



No.	Part no.	type	L (mm)	flow rate (L/h)	connection	material	fixing	suitable for	equiv. no.
1	500453	T6495	82	100	3/8" NPT	brass	clip connection	Vibiemme	POMPRONOSETN
2	500290	V3797	82	100	3/8" NPT	brass	clip connection	Cimbali	M31 Bistro
3	500230	V6105	82	180	3/8" NPT	brass	clip connection	Astoria CMA Rancilio	26302 26302 69000039



1

No.	Part no.	type	L (mm)	flow rate (L/h)	connection	material	fixing	suitable for	equiv. no.
1	500294	V6076	82	300	3/8" NPT	stainless steel	clip connection	-	-



No.	Part no.	type	L (mm)	flow rate (L/h)	connection	material	fixing	suitable for	equiv. no.
1	500454	PA1504	82	-	3/8" NPT	brass	clip connection	Vibiemme	POMPROCFL
2	500291	S2530	82	100	3/8" NPT	brass	clip connection	-	-
3	500292	S7900	82	180	3/8" NPT	brass	clip connection	-	-
4	500934	U0882	82	100	3/8" NPT	brass	clip connection	Cimbali	533197100



1

No.	Part no.	type	L (mm)	flow rate (L/h)	connection	material	fixing	suitable for	equiv. no.
1	500455	T6492	82	300	3/8" NPT	brass	clip connection	Vibiemme	POMPROCFLBYP

ROSSI



1

No.	Part no.	type	L (mm)	flow rate (L/h)	connection	material	fixing	suitable for	equiv. no.
1	504238	RF140S09E	82	100	3/8" NPT	brass	clip connection	Brasilia Nuova Simonelli	00604.4.00.08 01300005

accessories

No.	Part no.	Description
1	520157	adaptor for insulating coupling
2	500456	by-pass for PROCON pump
3	520126	clip for pump motor

No.	Part no.	Description
4	520155	coupling
5	527146	coupling set
6	520156	dumper coupling

No.	Part no.	Description
7	500066	coupling, flange connection complete
8	520158	coupling
9	365015	operating capacitor (capacity 10µF 450V)

No.	Part no.	Description
10	365017	operating capacitor (capacity 5µF 450V)
11	365012	operating capacitor (capacity 6.3µF 450V)

for wash pumps

No.	Part no.	power (W)	voltage (V)	freq. (Hz)	ph.	speed (rpm)	suitable for	equiv. no.
1	500288	2200/4000	400	50/60	3	1400/1700	Meiko	0501040
2	500285	550	230/400	50	3	1400	Meiko	0501016
3	500975	670/730	220-240	50/60	1	-	Hanning Winterhalter	WP60 122 3102481 60003595
4	500286	750	230/400	50	3	1380	Meiko	0501024

other

No.	Part no.	power (W)	voltage (V)	freq. (Hz)	L (mm)	usage	suitable for	equiv. no.
1	500692	180	230	50/60	140	for milk foamer	Thermoplan	90.39.10

**spindle motors****MAGNETIC**

No.	Part no.	type	voltage (V)	spindle ø (mm)	suitable for	equiv. no.
1	500609	MAX30-120-0050	24	28	Küppersbusch	120106
2	500622	MAX30-120-0050	24	29	Küppersbusch	120114



No.	Part no.	type	voltage (V)	ph.	spindle ø (mm)	suitable for	equiv. no.
1	500672	DSP4550-200-01	400	3	30	Electrolux Juno	0H6953 0H6953
2	500612	WSP2650-150-01	230	1	30	Ambach	5061207233

**MECVEL**

1

No.	Part no.	type	voltage (V)	spindle ø (mm)	suitable for	equiv. no.
1	500621	PP041.0012	24	16	Electrolux Zanussi	006690 006690

**SKF/ATB**

No.	Part no.	type	voltage (V)	spindle ø (mm)	suitable for	equiv. no.
1	500613	SRBFU0.09/2-B31R/0310	230	12	Ambach	5061214801
2	500614	SRBFU0.09/2-B31R/0311	230	12	Ambach	5061214601
3	500638	SRBFU0.09/2-B31R/X07	230	12	Ambach	5061214563

## timer motors

## CDC



No.	Part no.	CODE	supply (V)	turn direction	ø pinion/teeth
1	360325	M37LN	24	left	5.4 / 12
2	360131	M37LN	230	left	5.4 / 12
3	360324	M37RN	24	right	5.4 / 12
4	360119	M37RN	230	right	5.4 / 12

No.	Part no.	CODE	supply (V)	turn direction	ø pinion/teeth
5	360323	M48LATS	24	left	4.9 / 10
6	360083	M48LATS	230	left	4.9 / 10
7	360322	M48RATS	24	right	4.9 / 10
8	360118	M48RATS	230	right	4.9 / 10

## FIBER



No.	Part no.	CODE	supply (V)	turn direction	ø pinion/teeth
1	360117	M51B20L2200	24	left	4.3 / 10
2	360130	M51B20L6400	24	left	6.6 / 15
3	360116	M51B20R2200	24	right	4.3 / 10
4	360129	M51B20R6400	24	right	6.6 / 15
5	360063	M51BJ0L2200	230	left	4.3 / 10
6	360128	M51BJ0L6400	230	left	6.6 / 15
7	360062	M51BJ0R2200	230	right	4.3 / 10
8	360127	M51BJ0R6400	230	right	6.6 / 15
9	360321	M61B20L6400	24	left	6.6 / 15
10	360320	M61B20R6400	24	right	6.6 / 15
11	360319	M61B40L6400	230 (110V with pre-resistor)	left	6.6 / 15
12	360114	M61B40R6400	230 (110V with pre-resistor)	right	6.6 / 15

## SAIA



No.	Part no.	CODE	supply (V)	turn direction	ø pinion/teeth
1	360113	UDS11NE1LHZ	230	left	4 / 12